

2013
BASE MAP
TOWN OF LANGDON

INCORPORATED JANUARY 11, 1787
AND NAMED IN HONOR OF
JOHN LANGDON

THESE COPIES OF THE STATE OF NEW HAMPSHIRE
U.S. SENATOR & MEMBER OF THE CONVENTIONAL CONGRESS
COMPILED AND UPDATED BY
DANIEL J. LANGDON
OCT 11, 2000, AUGUST 8, 2013

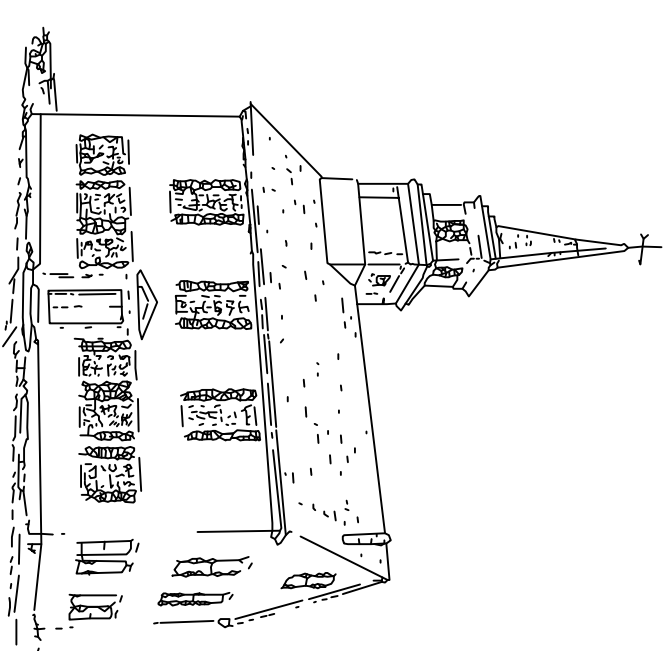

LANGDON
FEBRUARY 1976

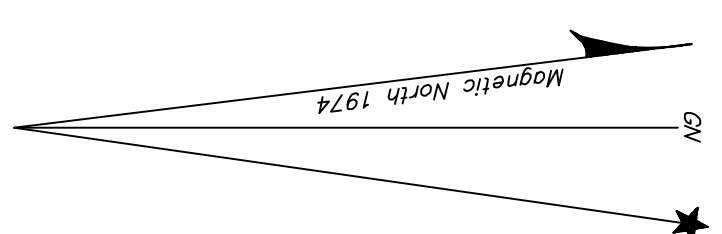

LEGEND
NUMBER INDEXING SYSTEM EXPLAINED BELOW

MARSH LANDS
RIVERS & STREAMS
NATURAL PONDS
FARM & FIRE PONDS
BEAVER PONDS

PANEL NUMBER
THIS MAP REFERENCE
NUMBER IS 1002

GRID NUMBER LEFT
6TH SQUARE FROM BOTTOM

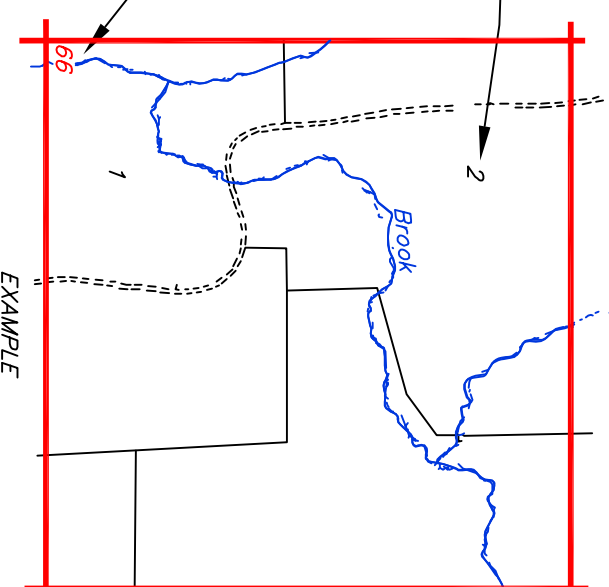

EXAMPLE



This document was created with the Win2PDF "print to PDF" printer available at
<http://www.win2pdf.com>

This version of Win2PDF 10 is for evaluation and non-commercial use only.

This page will not be added after purchasing Win2PDF.

<http://www.win2pdf.com/purchase/>